

1 Property Owner - Refer to Property Number on Postcard. Numbers may shift due to real estate transactions from the initial notification.

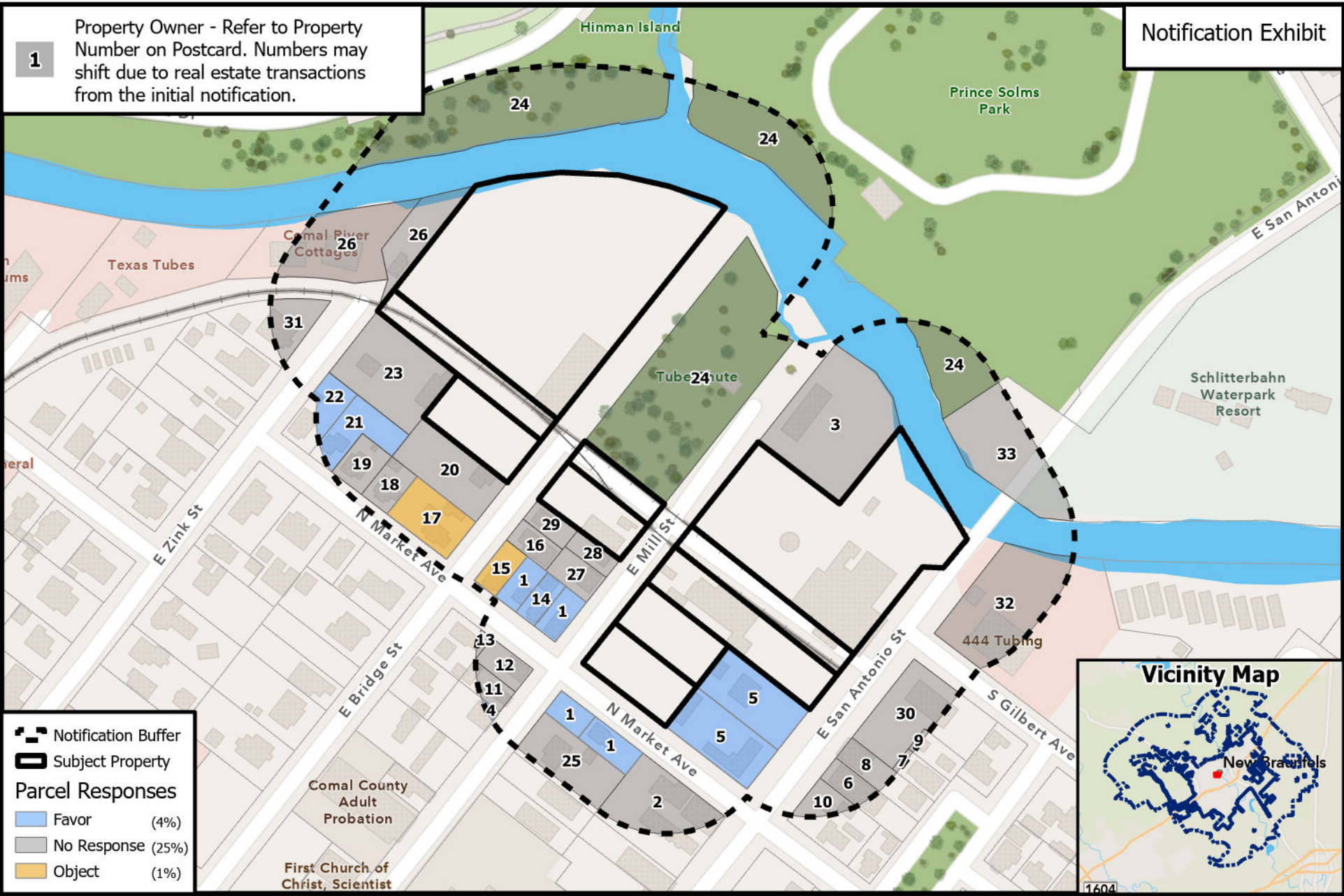

Notification Buffer
Subject Property

Parcel Responses

- Favor (4%)
- No Response (25%)
- Object (1%)

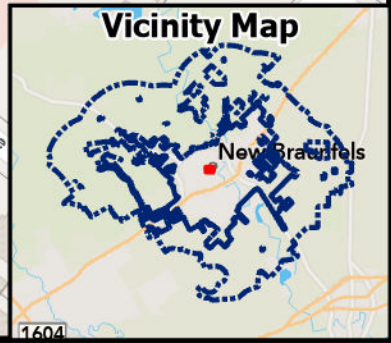

SUP24-338
C-2, C-4, M-1 to MU-B with Type 1 SUP

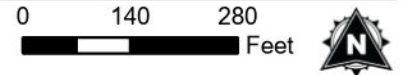

PLANNING COMMISSION – November 6, 2024 – 6:00 PM

City Hall Council Chambers

Applicant: Killen, Griffin & Farrimond, PLLC

Address/Location: 373 & 403 E. Bridge St., 312, 340 & 373 E. Mill St., and 385 & 401 E. San Antonio St.

CASE #SUP24-338

The numbers on the map correspond to the property owners listed below. All information is from the Appraisal District Records. The property under consideration is marked as "Subject Property".

- | | | | |
|----|----------------------------------|----|----------------------------------|
| 1 | NOLTE MELVIN JR | 18 | RIZZATTO JAMES |
| 2 | MUCKENFUSS PROPERTIES LLC | 19 | MORALES ELEANOR A |
| 3 | FOUNTAINNEER INVESTMENTS LLC | 20 | CARRASCO GUADALUPE ET AL |
| 4 | TAMEZ INVESTMENTS LLC - SERIES A | 21 | CAMPOS ATANACIO |
| 5 | FARMERS MUTUAL FIRE | 22 | KOBESKI LEONARD J JR & FRANCES K |
| 6 | KIESLING BOB R & BETTY A | 23 | HERBELIN CARL B |
| 7 | BUCHE JOHN K & HOLLY H | 24 | NEW BRAUNFELS CITY OF |
| 8 | CABANA SOCIAL CLUB LLC | 25 | CASTEEL PARTNERS LTD |
| 9 | KORMAN GREG | 26 | STUDDARD STILL RUTLEDGE LLC |
| 10 | MATHIS GARY D | 27 | QDREAM LLC |
| 11 | CASTEEL PARTNERS LP | 28 | PARRAS JEFFREY J & SABRINA K |
| 12 | MOZELEY-JACQUES RENTALS LLC | 29 | STONE OAK CAPITAL LLC |
| 13 | BEHRENS JAY & MORGAN | 30 | ESA PARTNERS LLC |
| 14 | NOLTE MELVIN JR ET AL | 31 | GLADDEN MICHAEL W |
| 15 | RIVERSTONE ADVISORS, LLC | 32 | IAKOBO 4 LP |
| 16 | GMI PROPERTIES INC | 33 | NEW BRAUNFELS WATERPARK LLC |
| 17 | LEATHERWOOD PAUL W | | |

SEE MAP

TAMEZ INVESTMENTS LLC - SERIES A

532 ROCK ST

NEW BRAUNFELS TX 78130

Property #: 4

SUP24-338

Case Manager: ML

FAVOR



OPPOSE



COMMENTS

LEATHERWOOD PAUL W

307 E BRIDGE ST

NEW BRAUNFELS TX 78130

Property #: 17

SUP24-338

Case Manager: ML

FAVOR



OPPOSE



COMMENTS

RIVERSTONE ADVISORS, LLC

480 W MILL ST

NEW BRAUNFELS TX 78130

Property #: 15

SUP24-338

Case Manager: ML

COMMENTS

FAVOR



OPPOSE



FARMERS MUTUAL FIRE
309 E SAN ANTONIO ST
NEW BRAUNFELS TX 78130

Property #: 5
SUP24-338
Case Manager: ML

FAVOR
OPPOSE

COMMENTS

I believe the most crucial aspect of this development is ensuring that the developers are held accountable for complying with city parking codes and providing designated spaces to accommodate the anticipated volume of visitors.

The Gruene area, where single-family homes and businesses coexist, highlights the importance of sufficient parking to meet the needs of growing developments. Inadequate parking can create significant challenges for the surrounding community (as we are keenly aware currently downtown).

Could you share the specific plans this development has in place to support the increased density and effectively manage the resulting parking demands? We would greatly appreciate your response to this inquiry.

Please feel free to email me at jsalge@fmfia.com with your reply.

Best regards,

Josh Salge- General Manager at Farmers Mutual Ins.

KOBESKI LEONARD J JR & FRANCES K
394 N MARKET
NEW BRAUNFELS TX 78130

Property #: 22
SUP24-338
Case Manager: ML

FAVOR
OPPOSE

COMMENTS

NOLTE MELVIN JR ET AL
175 N MARKET ST
NEW BRAUNFELS TX 78130

Property #: 14
SUP24-338
Case Manager: ML

COMMENTS

FAVOR
OPPOSE

NOLTE MELVIN JR
175 N MARKET ST
NEW BRAUNFELS TX 78130

Property #: 1
SUP24-338
Case Manager: ML

COMMENTS

FAVOR
OPPOSE

CAMPOS ATANACIO

PO BOX 310859

NEW BRAUNFELS TX 78131

Property #: 21

SUP24-338

Case Manager: ML

COMMENTS

FAVOR

OPPOSE