

This rendering proposed with additional 287.5 sq ft.

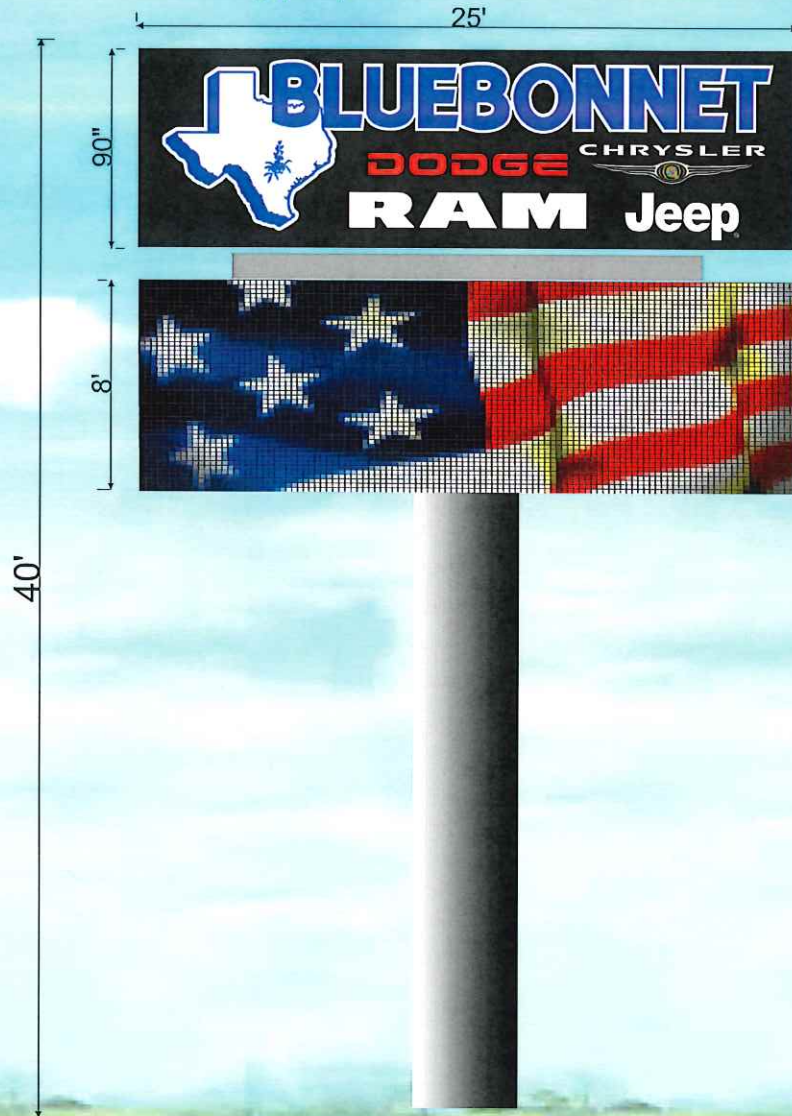

This rendering to code

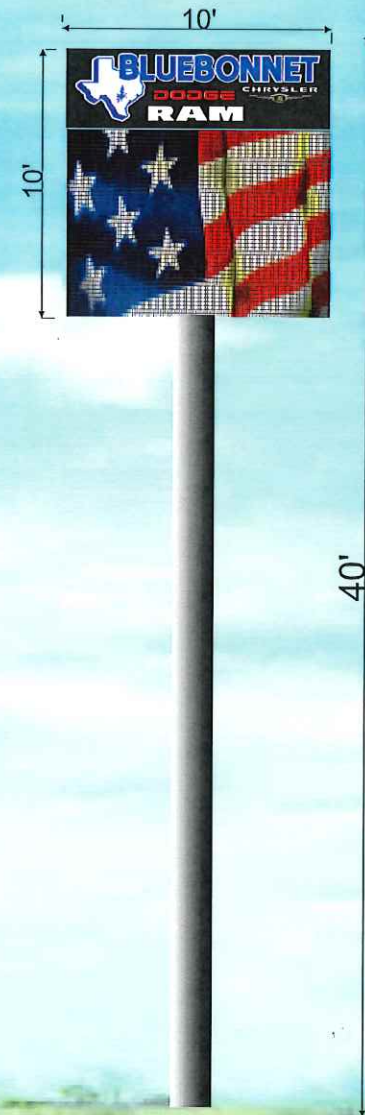

State License TSCL 18159  
Regulated by The Texas Dept. of Licensing & Regulation, P.O. Box 12157, Austin, TX, 78711  
 1-800-853-9002 www.tdlr.state.tx.us/complaints

258 TRADE CENTER DRIVE  
 NEW BRAUNFELS, TEXAS 78130  
 830.629.4411 FAX 830.629.8099  
 ussignnb@gmail.com • www.ussignsnb.com



Client **Blue Bonnet Dodge 1310 IH 35**

Approval

Date

All drawings submitted are property of U.S. Signs until purchased by The Client. No alterations or distributions can be made without written consent from U.S. Signs

THIS SIGN IS INTENDED TO BE INSTALLED IN ACCORDANCE WITH THE REQUIREMENTS OF ARTICLE 600 OF THE NATIONAL ELECTRICAL CODE AND/OR OTHER APPLICABLE LOCAL CODES. THIS INCLUDES PROPER GROUNDING AND BONDING OF THE SIGN.





**DODGE**

**Jeep**



**RAM**

**SIGN DETAIL**

**CDR+J Silver Jeep on Top -  
9 Series Pylon @ 35' OAH**

**N-01**

**SQUARE FOOTAGE**

158.57 sq ft

**MANUFACTURING DETAILS**



- PAINTED ALUMINUM SIGN CONSTRUCTION WITH CHROME ACCENTS ON CLADDING
- 3M FACES w/ 1ST SURFACE DECORATION VINYL/ COLOR DIGITAL PRINT

**ILLUMINATION**

LEDS INTERNAL ILLUMINATION  
CIRCUITS REQUIRED ( 1) 20 AMP

**ALL ELECTRICAL COMPONENTS TO BE UL LISTED  
GROUNDING PER UL AND NEC SPECIFICATIONS**

**COLORS**

- BLACK 
- BLUE PMS 287 
- RED PMS 1797C 
- SILVER 

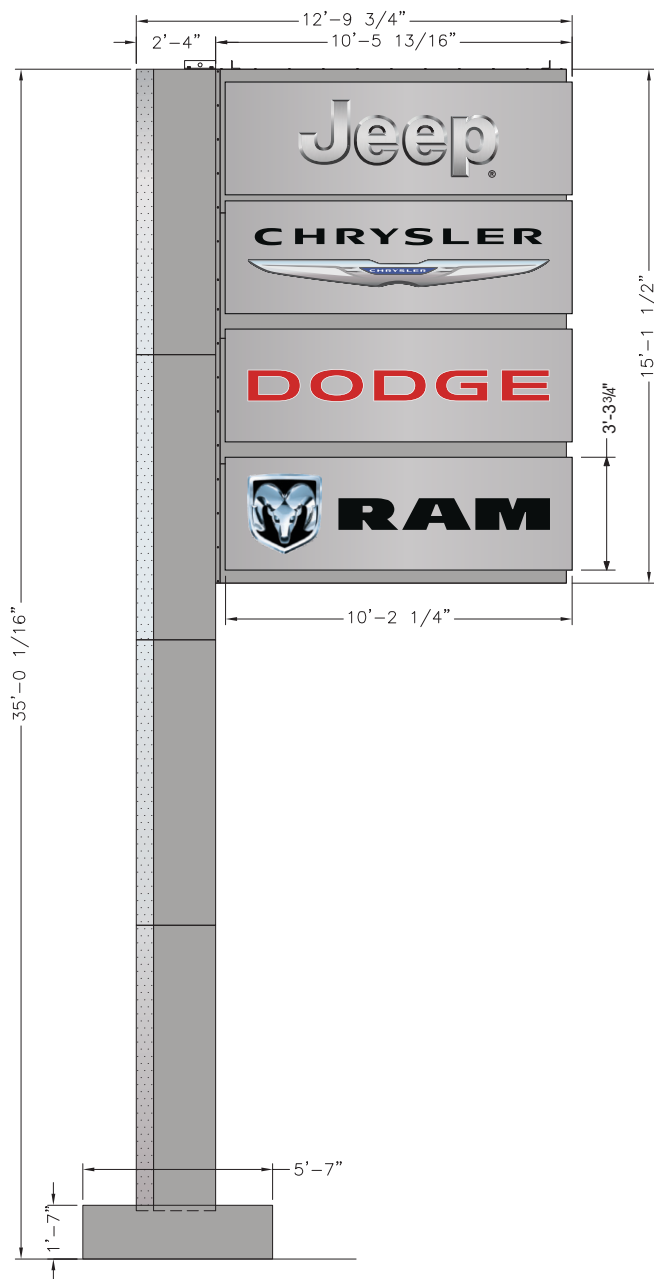

- ### KEYNOTES
- LIGHT POLE, REF. MEP, STRUCT., # DETAIL 2/G2.0
  - SINGLE DUMPSTER ENCLOSURE, REF. STRUCTURAL # DETAIL 14/G2.1
  - 6" CONCRETE FILLED BOLLARD, REF. DETAIL 9/G2.1
  - DOUBLE DUMPSTER ENCLOSURE, REF. DETAIL 15/G2.1, REF. STRUCTURAL
  - FIRE DEPARTMENT CONNECTION, REF. MEP
  - LANDSCAPING AREA, REF. LANDSCAPE DWGS
  - 1" IRRIGATION METER, REF. CIVIL # LANDSCAPE DWGS
  - ADA PARKING SIGN, REF. DETAIL 2/G2.1
  - ADA RAMP, REF. CIVIL
  - SIDEWALK, REF. CIVIL
  - HOSE BIB, REF. LANDSCAPING # MEP
  - PARKING LOT MARKINGS, REF. CIVIL
  - FIRE LANE, REF. CIVIL
  - ELECTRICAL TIE IN, REF. CIVIL AND MEP
  - ADA PATH OF TRAVEL
  - DUMPSTER BY OWNER
  - DOMESTIC WATER METER, REF. CIVIL
  - PREFINISHED DOWNSPOUT TO TIE INTO UNDERGROUND STORM DRAIN, REF. CIVIL # DETAIL 18/AG.6
  - NEW GROUND TRANSFORMER, REF. CIVIL AND MEP
  - GOLF CART PARKING
  - CIRCULAR VEHICLE DISPLAY WITH STAINED CONCRETE, REF. CIVIL # MEP FOR LIGHTNING REQUIREMENTS
  - ROLL-OVER CURB, REF. CIVIL
  - 80'-0" TALL FLAGPOLE, REF. SPECS, STRUCTURAL, # DETAIL 1/G2.2
  - PLYON SIGN, BY OWNER, COORDINATE EXACT LOCATION WITH SIGNAGE PROVIDER, PROVIDE ELECTRICAL CONDUIT WITH PULL STRING, REF. MEP
  - LEVEL 2 EV CHARGER, PROVIDE (2) 3/4" CONDUIT PER MANUFACTURER, REF. MEP
  - LEVEL 3 EV CHARGER, PROVIDE (1) 3/4" (1) 1/2" CONDUIT PER MANUFACTURER, REF. MEP
  - JEOP MOUNTAIN ROCKSCAPE, REF. STRUCTURAL AND MEP
  - SITE STAIRS, REF. CIVIL AND DETAIL 3/G2.1
  - UNDERGROUND DETENTION, REF. CIVIL
  - FDC CONNECTION
  - REINFORCED CONCRETE APRON, REF. STRUCTURAL
  - FLUSH RIBBON CURB, REF. CIVIL
  - GAS METER, REF. CIVIL
  - STORM WATER LINE, REF. CIVIL # MEP
  - SANITARY SEWER LINE, REF. CIVIL # MEP
  - SAND / OIL SEPARATOR, REF. CIVIL # MEP
  - NEW CAR DELIVERY CANOPY OVERHEAD REF. DETAIL XXXX
  - DOMESTIC WATER LINE, REF. CIVIL # MEP
  - FIRE LINE, REF. CIVIL # MEP
  - SEGMENTED BLOCK RETAINING WALL TO BE PERMITTED SEPARATELY, REF. CIVIL
  - MECHANICAL UNITS, REF. MEP
  - QUICK CHECK DRIVE AND QUICK TREAD EDGE, REF. EQUIPMENT SCHEDULE, STRUCTURAL # MEP
  - WHEEL STOP, REF. CIVIL
  - DECORATIVE STAINED CONCRETE, REF. CIVIL AND SPECS
  - SERVICE DRIVE CANOPY OVERHEAD
  - CHAIN LINK FENCE, REF. CIVIL # DETAIL 4/G2.1
  - 4" STANDARD PIPE RAILING, REF. CIVIL # DETAIL 7/G2.3
  - GUARD RAIL DIRECTLY BEHIND THE RETAINING WALL, REF. CIVIL # DETAIL 3/G2.0
  - SECURITY GATE, REF. CIVIL # DETAIL 1/G2.3
  - (2) 4" CONDUIT TO ADJACENT ELECTRICAL ROOM FOR FUTURE USE, REF. MEP
  - NEW ADA SIDEWALK ACCESS, REF. CIVIL
  - DIRECTIONAL SIGN PER OWNER, REF. CIVIL
  - HEAVY DUTY CONCRETE PAVING, REF. CIVIL
  - ASPHALT PAVING, REF. CIVIL
  - DECORATIVE 6" SCREEN WITH GATE AROUND MECHANICAL UNITS, COORDINATE WITH MEP REQUIRED CLEARANCES AROUND GROUND MOUNTED UNITS. HOLD FENCE AS TIGHT AS POSSIBLE.
  - WET RATED RECESSED UPLIGHTING, REF. MEP
  - VEHICLE DISPLAY LIGHTING, REF. MEP
  - BOLLARD WITH LOCKING MECHANISM TO ACCEPT GATE, REF. DETAIL
  - SITE LIGHTING POLE AT THIS LOCATION SHALL BE PROVIDED WITH 20 AMP 120 VOLT WATERPROOF ELECTRICAL DUPLEX RECEPTACLE, REF. MEP
  - PROVIDE ELECTRICAL DIGITAL ON-SITE SIGN THIS LOCATION, COORDINATE EXACT MANUFACTURER, SIZE, LOCATION AND ELECTRICAL REQUIREMENTS WITH OWNER PRIOR TO PURCHASE. ALL SIGNAGE SHALL REQUIRE SEPARATE CITY OF NEW BRAUNFELS SIGNAGE PERMIT.
  - 36'-0" ROLLING GATE, FIELD VERIFY, REF. DETAIL 9/G2.3
  - 34'-6" ROLLING GATE, FIELD VERIFY, REF. DETAIL 9/G2.3
  - 37'-0" ROLLING GATE, FIELD VERIFY, REF. DETAIL 9/G2.3
  - 30'-0" ROLLING GATE, FIELD VERIFY, REF. DETAIL 9/G2.3
  - METAL TRACK, REF. DETAIL 10/G2.3
  - CURB CUT, REF. CIVIL
  - FUTURE LEVEL 3 EV CHARGING STATION, PROVIDE (1) 3/4" (1) 1/2" CONDUIT WITH PULL STRING AND CAP THE END, REF. MEP
  - (2) 4" CONDUIT TO ADJACENT IT ROOM AND BETWEEN IT ROOMS, REF. MEP

- ### GENERAL NOTES
- ROOF DRAINS AND DOWNSPOUTS ARE TO BE CONNECTED DIRECTLY TO UNDER GROUND STORM WATER SYSTEM.
  - DEMOLITION OF ALL EXISTING SITE ELEMENTS SHALL HAVE BEEN COMPLETED AND CONSTRUCTION PERMIT ACQUIRED PRIOR TO THE START OF ANY NEW SITE WORK. GENERAL CONTRACTOR SHALL FIELD VERIFY ALL EXISTING SITE CONDITIONS FOR ANY ITEMS OF EXISTING CONSTRUCTION THAT WOULD INTERFERE OR CONFLICT WITH REQUIREMENTS OF NEW CONSTRUCTION. TYPICAL WITHOUT EXCEPTION. CONTRACTOR SHALL NOTIFY ARCHITECT OF ANY AND ALL ITEMS OF CONFLICT PRIOR TO SITE DISTURBANCE AND/OR START OF CONSTRUCTION.
  - PRIOR TO START OF BUILDING CONSTRUCTION CONTRACTOR SHALL FIELD VERIFY AND LOCATE ALL EXISTING UTILITY LINES THAT WILL PROVIDE SERVICE TO THE FACILITY, INCLUDING BUT NOT LIMITED TO WATER, SANITARY SEWER, STORM DRAINAGE, ELECTRICAL, NATURAL GAS, TELEPHONE, ETC.
  - GUARD RAIL TO BE PLACED BEHIND RETAINING WALL WHEREVER THERE IS NOT A CHAIN LINK FENCE. PIPE RAIL IS TO BE PLACED AROUND THE REMAINING PARAMETER.
  - PLYON SIGN: CONTRACTOR TO PROVIDE PRIMARY ELECTRICAL TO WITHIN 6' OF SIGN. ELECTRICAL FOR GROUND SIGN MUST MEET CURRENT NEC STANDARDS AND HAVE A 20-AMP DEDICATED CIRCUIT. PRINCIPLE WILL INSTALL A NEW BRAND SIGN AND MAKE FINAL ELECTRICAL CONNECTION. PLYON & DIRECTION SIGN FOUNDATIONAL FOOTINGS BY SIGNAGE PROVIDER. SIGNAGE TO BE PERMITTED SEPARATELY.
  - BUILDING SIGNAGE: CONTRACTOR TO PROVIDE A MINIMUM 3/4" PLYWOOD BACKING BEHIND SIGNS AND PRIMARY ELECTRICAL AT POINT OF INSTALLATION. CONTRACTOR TO PROVIDE A MINIMUM 2'X2' ACCESS PANEL AT EACH SIGN LOCATION. PRINCIPLE WILL INSTALL NEW DEALER NAME LETTERS, CHRYSLER, DODGE AND RAM BADGES, AND MAKE FINAL ELECTRICAL CONNECTION.
  - CONTRACTOR TO COORDINATE KNOX BOX LOCATION WITH LOCAL FIRE MARSHAL.
  - CONTRACTOR TO COORDINATE WITH OWNER CAMERA PLACEMENT AND REQUIRED CONDUIT PRIOR TO SITE POUR.
  - ALL CURBS ARE TYPICAL 6" CURBS UNLESS NOTED OTHERWISE. REFERENCE CIVIL.

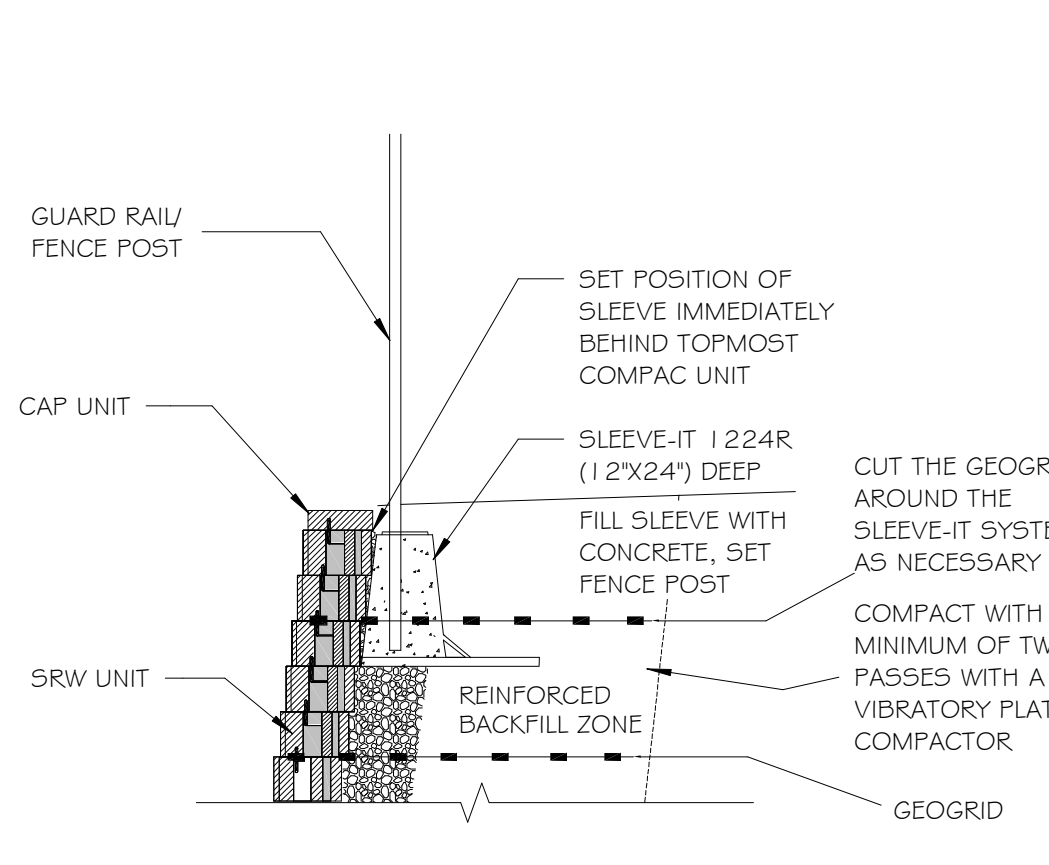
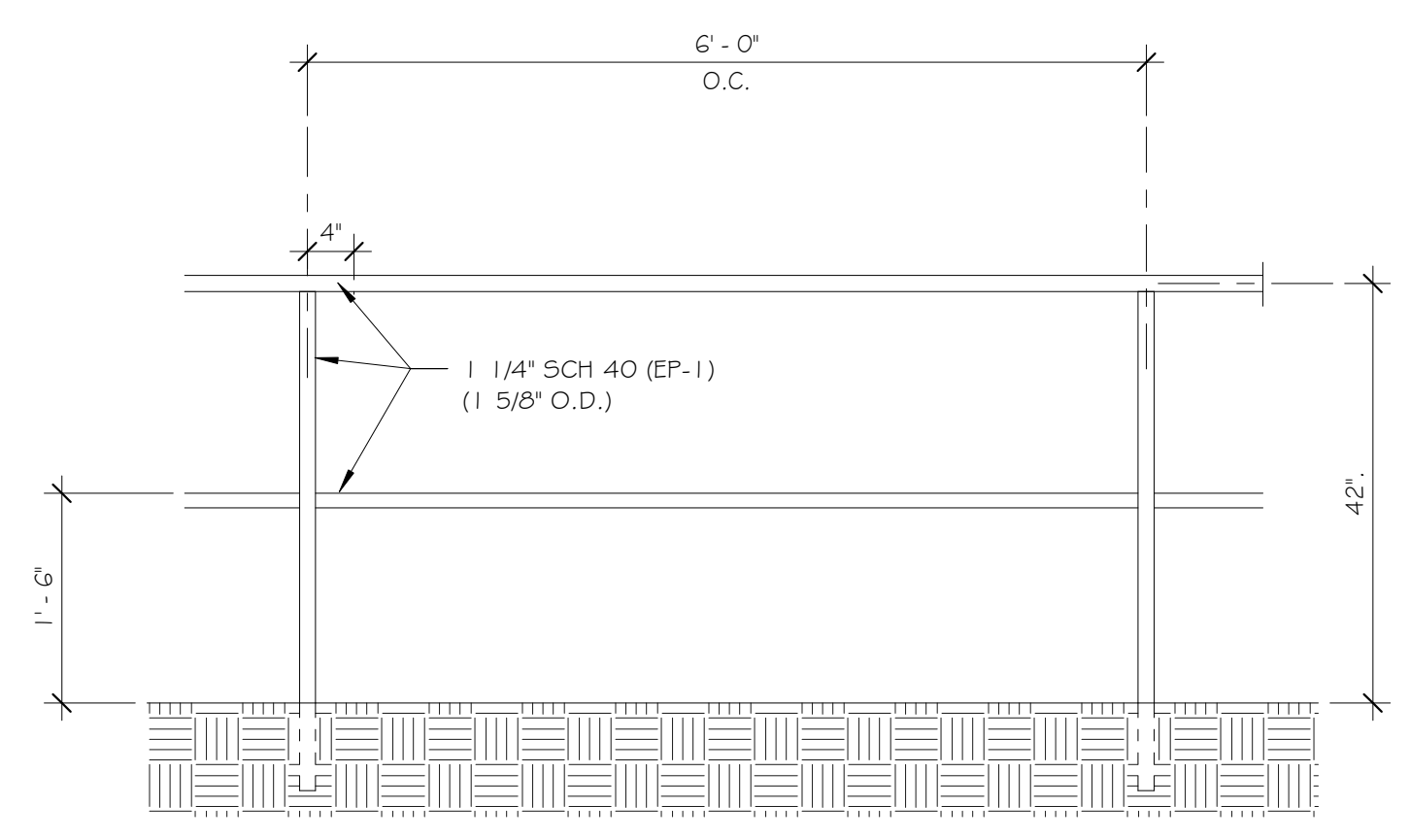

NOTE:  
• PARKING STRIPING ON CONCRETE TO BE CHARCOAL GRAY (SW 3063)  
• PARKING STRIPING ON ASPHALT TO BE WHITE

### PARKING COUNT

SALES BLDG (1: 200 S.F.)	103
SERVICE SHOP (3: 1 BAYS)	156
PARTS AREA (1: 1,000 S.F.)	19
DISPLAY VEHICLES	395
ADA PARKING*	7
<b>TOTAL</b>	<b>673</b>

\*ADA PARKING COUNT INCLUDED IN SALES BLDG TOTAL

### LEGEND

	FENCE LINE
	PIPE RAIL / GUARD RAIL
	RETAINING WALL
	PROPERTY LINE
	BLDG. SETBACK & EASEMENT LINE
	UTILITY LINES
	FIRE LANE
	HEAVY DUTY CONCRETE PAVING
	STAINED CONCRETE PAVING

**1 ARCHITECTURAL SITE PLAN**  
SCALE: 1" = 30'-0"

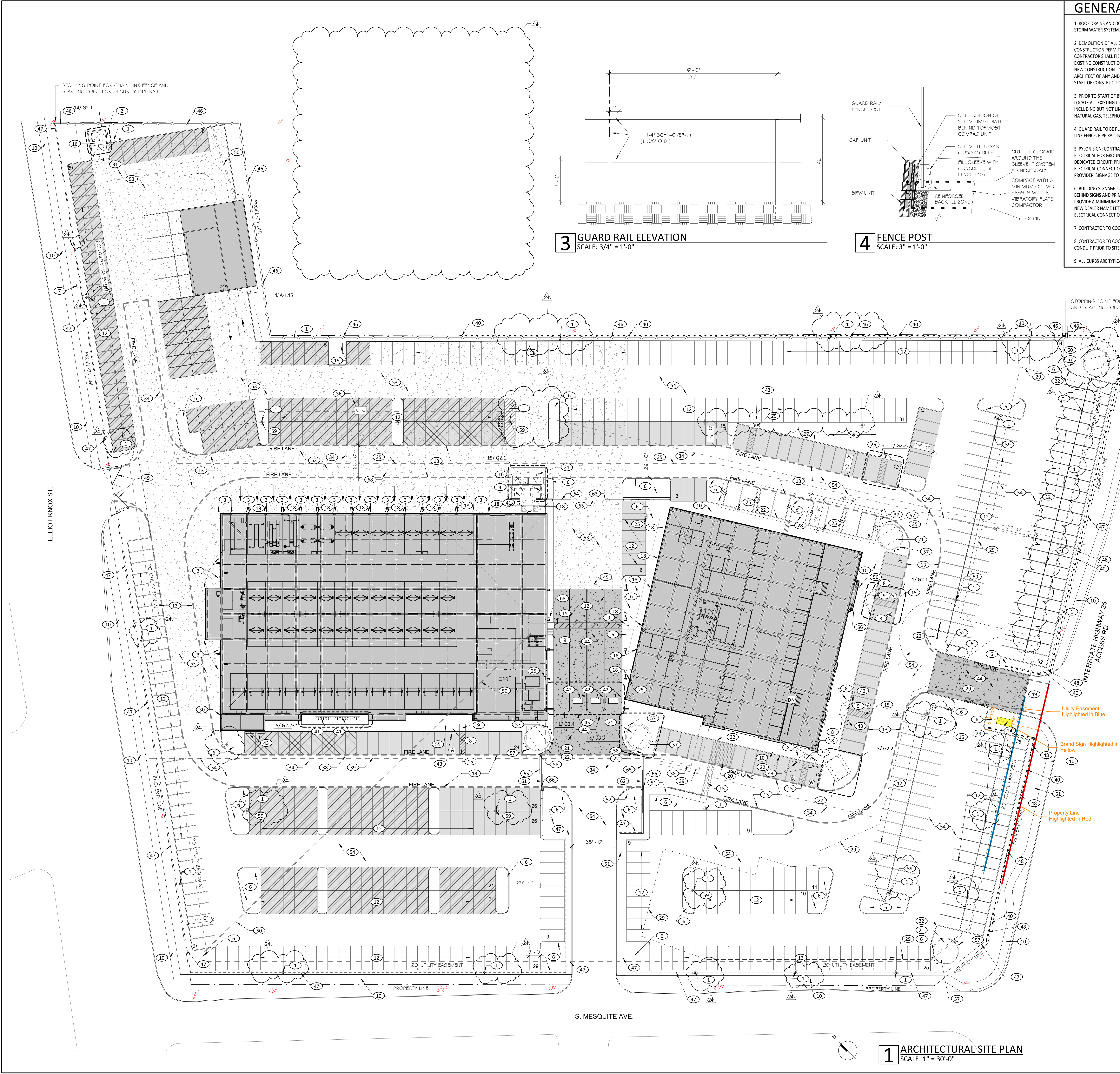

This project is to provide signage identification and product advertising for the new Dodge dealership.

The current code interpretation restricts a static sign cabinet with a LED message center added to a total aggregate of 100 square feet. The location of this proposed sign is on IH 35. Which allows the structure to be 40' in height. A 100 square foot sign on a 40' pylon structure would not suffice for visibility at the rate of speed drivers are driving on IH 35. We are proposing to build the same size sign as Bluebonnet Ford has. But 10' shorter in height. (please see attached paperwork).

We are asking for an additional 287.5 sq ft of sign area and will not be asking for any increase in height.

With the existing signs as these on IH 35, and the property size this structure will be built on, is over 2 city blocks , this sign size will fit within the development.



State License TSCL 18159  
Registered by The Texas Dept. of Licensing & Regulation, P.O. Box 12187, Austin, TX 78711  
1-800-803-9222 www.tdlr.state.tx.us/licensing

258 TRADE CENTER DRIVE  
NEW BRAUNFELS, TEXAS 78130  
830.629.4411 FAX 830.629.8099  
ussignnb@gmail.com • www.ussignsnb.com



Client



1310 IH 35

Approval

Date

All drawings submitted are property of U.S. Signs until purchased by The Client. No alterations or distributions can be made without written consent from U.S. Signs

THIS SIGN IS INTENDED TO BE INSTALLED IN ACCORDANCE WITH THE REQUIREMENTS OF ARTICLE 600 OF THE NATIONAL ELECTRICAL CODE AND/OR OTHER APPLICABLE LOCAL CODES. THIS INCLUDES PROPER GROUNDING AND BONDING OF THE SIGN.

40' with 100 sq ft per code/



40' with additional 287.5 sq ft



State License TSCL 18159

258 TRADE CENTER DRIVE  
NEW BRAUNFELS, TEXAS 78130  
830.629.4411 FAX 830.629.8099  
ussignsnb@gmail.com • www.ussignsnb.com



Client **Blue Bonnet Dodge 1310 IH 35**

Approval

Date

# Bluebonnet Ford 351 IH 35



This sign is the same size as what is being requested for Bluebonnet Dodge, but will be 10' shorter in height. This structure is 50' in height.

# RBCU 960 IH 35



21' x 18' = 378 sq ft



State License TSCL 18159  
Regulated by The Texas Dept. of Licensing & Regulation, P.O. Box 12197, Austin, TX 78711  
 1-800-803-9022 www.tdlr.state.tx.us

258 TRADE CENTER DRIVE  
 NEW BRAUNFELS, TEXAS 78130  
 830.629.4411 FAX 830.629.8099  
 ussignnb@gmail.com • www.ussignsnb.com



Client

Approval

Date

All drawings submitted are property of U.S. Signs until purchased by The Client. No alterations or distributions can be made without written consent from U.S. Signs

THIS SIGN IS INTENDED TO BE INSTALLED IN ACCORDANCE WITH THE REQUIREMENTS OF ARTICLE 600 OF THE NATIONAL ELECTRICAL CODE AND/OR OTHER APPLICABLE LOCAL CODES. THIS INCLUDES PROPER GROUNDING AND BONDING OF THE SIGN.