



16719 Huebner Rd., Suite 301
San Antonio, TX 78248
210.408.7553
www.msasfa.com

THIS PLAN AND THE DESIGNS CONTAINED HEREIN ARE THE PROPERTY OF MSA OF SAN ANTONIO, INC. AND SHALL NOT BE REPRODUCED, ALIEN, OR IN ANY MANNER WITHOUT THE WRITTEN CONSENT OF MSA OF SAN ANTONIO, INC.

MSA OF SAN ANTONIO, INC. IS A PROFESSIONAL ARCHITECTURE FIRM. THE ARCHITECT HAS NOT AN ENGINEERING FIRM. HE DOES NOT QUALIFY TO BE THE ARCHITECT OF RECORD FOR ANY STRUCTURAL, MECHANICAL, ELECTRICAL, OR PLUMBING. A LICENSED PROFESSIONAL ENGINEER SHOULD BE CONSULTED FOR ALL STRUCTURAL, MECHANICAL, ELECTRICAL, AND PLUMBING. THE ARCHITECT HAS NOT BEEN LICENSED IN ANY OTHER STATE. THE ARCHITECT HAS NOT BEEN LICENSED IN ANY OTHER STATE. THE ARCHITECT HAS NOT BEEN LICENSED IN ANY OTHER STATE. THE ARCHITECT HAS NOT BEEN LICENSED IN ANY OTHER STATE.

ARCHITECT'S SEAL

THIS SET OF DRAWINGS IS FOR INTERIM REVIEW ONLY. THIS DOCUMENT IS INCOMPLETE AND NOT FOR REGULATORY APPROVAL, PERMITTING, BIDDING OR CONSTRUCTION.

BRENT R ANDERSON
REGISTRATION NO. 17241

DATE	REVISION
Date 5	Revision 5

A RESIDENCE FOR
DRS. MOORE
720 KLINGEMANN
LOTS 1 & 2
LANDA PARK ESTATES

KEITH WING
CUSTOM BUILDERS

REQUEST FOR VARIANCE PLAN

#6 OF 5
3-3051

© COPYRIGHT 2020 MSA OF SAN ANTONIO, INC. ALL RIGHTS RESERVED

Request for Variance on Setback

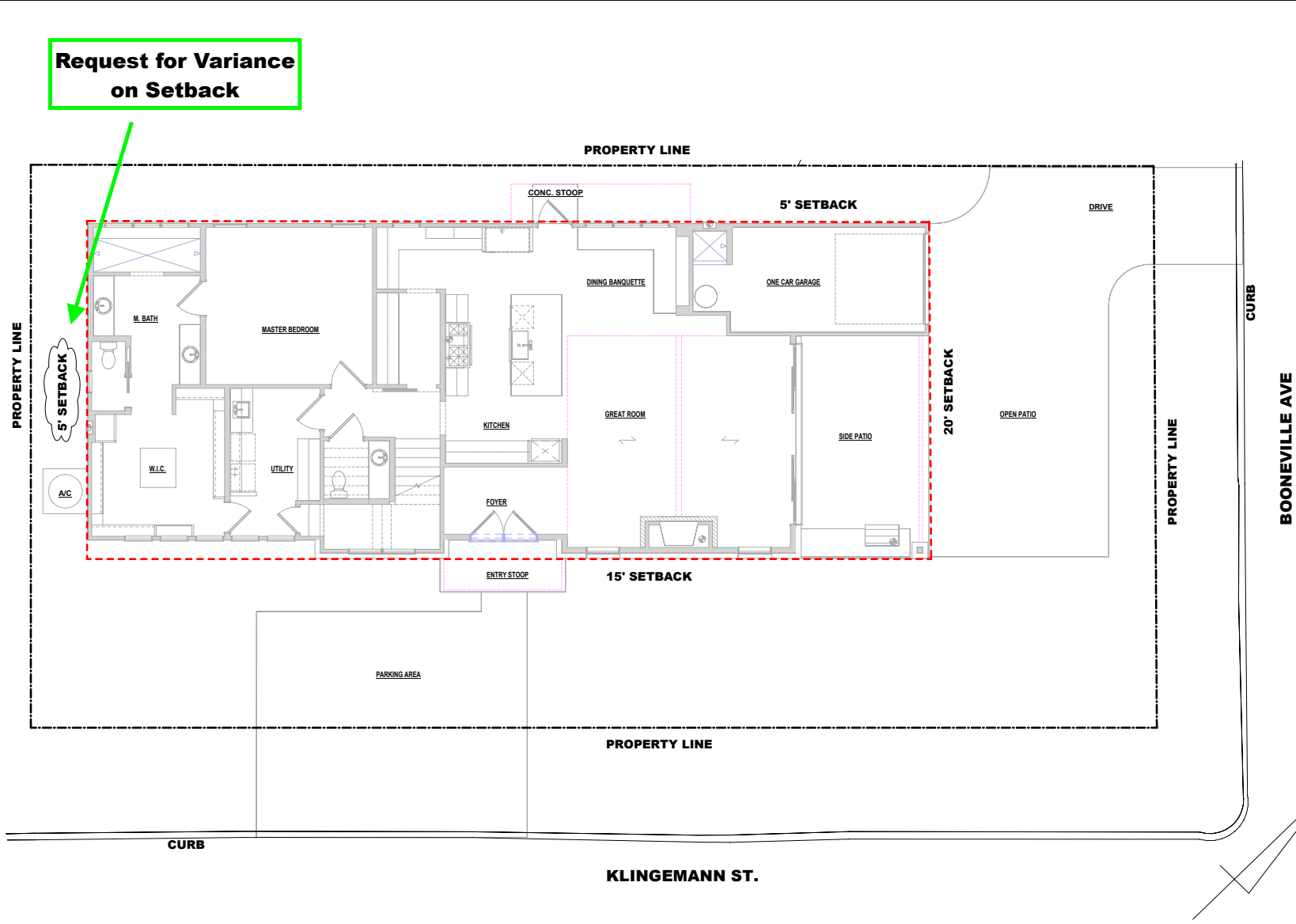
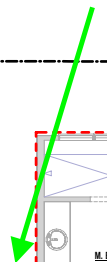

1 REQUEST FOR VARIANCE PLAN
1/4" = 1'-0"

9/19/2020 4:58:53 AM C:\Users\Keth\Documents\KW\Buildings\Keth\WMOORE DD SET 9-18-20.rvt