

REV. #:	REVISIONS:	REVISED BY:	DATE:
5	REMOVED DETAIL #19 "SCREEN TRACK FILLER" RIGHT SIDE ONLY	P.A.T.	11/18/03
6	DH7501S WAS DH7501, DH0903S WAS DH0703	P.A.T.	04/07/04
7	Updated drawing with weeping screen corner	JDD	07/11/06
8	UPDATED SERIES 7500 TO GENERATIONS.	T.D.D.	11/13/06
9	ADDED POLAR WALL TO SERIES IN THE TITLE BLOCK.	T.D.D.	05/03/07

PARTS LIST

1	JAMB -DH7501S
2	HEAD -DH7501S
3	HEAD INSERT -DH72
4	SCREEN CLOTH
5	JAMB ADJUSTOR SCREW
6	JAMB ADJUSTOR HOUSING
7	BALANCE SPRING
8	BALANCE DRUM
9	BALANCE COVER
10	BALANCE SCREW
11	WEEP COVER
12	STEPPED SILL -DH0903S
13	CAVITY PLUG/SASH STOP
14	SIDE BRAKING BALANCE SHOE
15	SCREEN SPLINE
16	WEEPING SCREEN CORNER
17	SCREEN FRAME
18	BALANCE CAM
19	SASH STOP

DISCLOSURE STATEMENT

This document is the property of Simonton Windows, which retains all proprietary and other rights to its subject matter. This document is provided to the recipient on the expressed condition that it is not to be disclosed, reproduced in whole or part, nor used in conjunction with the design, manufacture or repair of goods for anyone other than Simonton Windows without its consent. This restriction does not limit the recipient's rights to utilize information contained in this document which is properly obtained from another source.

MATERIAL:

RMS FINISH:	EXCEPT AS NOTED
ALLOY & TEMPER:	
WEIGHT:	VOLUME:
SURFACE AREA:	PERIMETER:
FINISH TREATMENT:	

Dimensional Tolerances  
Unless Otherwise Specified

Decimals	Angles
.X ± .03	
.XX ± .01	0° 30 min.
.XXX ± .005	



1 Cochrane Avenue  
Pennsboro, WV 26415

SIZE: A	DRAWING NO.: 1318	REV.: 9
DRAWN BY: P.S.B.	DATE: 12/04/97	
CHECKED BY:	DATE:	
APPR'VD BY:	DATE:	

SCALE: FIT	SHEET: 1 OF 1
------------	---------------

SERIES: 6500, GENERATIONS & POLAR WALL - DOUBLE HUNG

TITLE: FRAME EXPLODED ISOMETRIC

REV. #:	REVISIONS:	REVISED BY:	DATE:
10	CHANGED SUPER SERVICE I.G. THICKNESS.	T.D.D.	07/09/07
11	CORRECTED STEEL REINFORCEMENT IN KEEPER RAIL.	T.D.D.	04/23/10
12	ADDED EXTERIOR COLOR FIN SEAL TABLE	DWB	06/10/10
13	Updated the aluminum numbers due to a vendor transition. ECO 22-014.	RTW	7/25/22
14	Replaced the 32001 head insert bulb with the 2500 bulb per ECO 21-030.	RTW	1/26/23

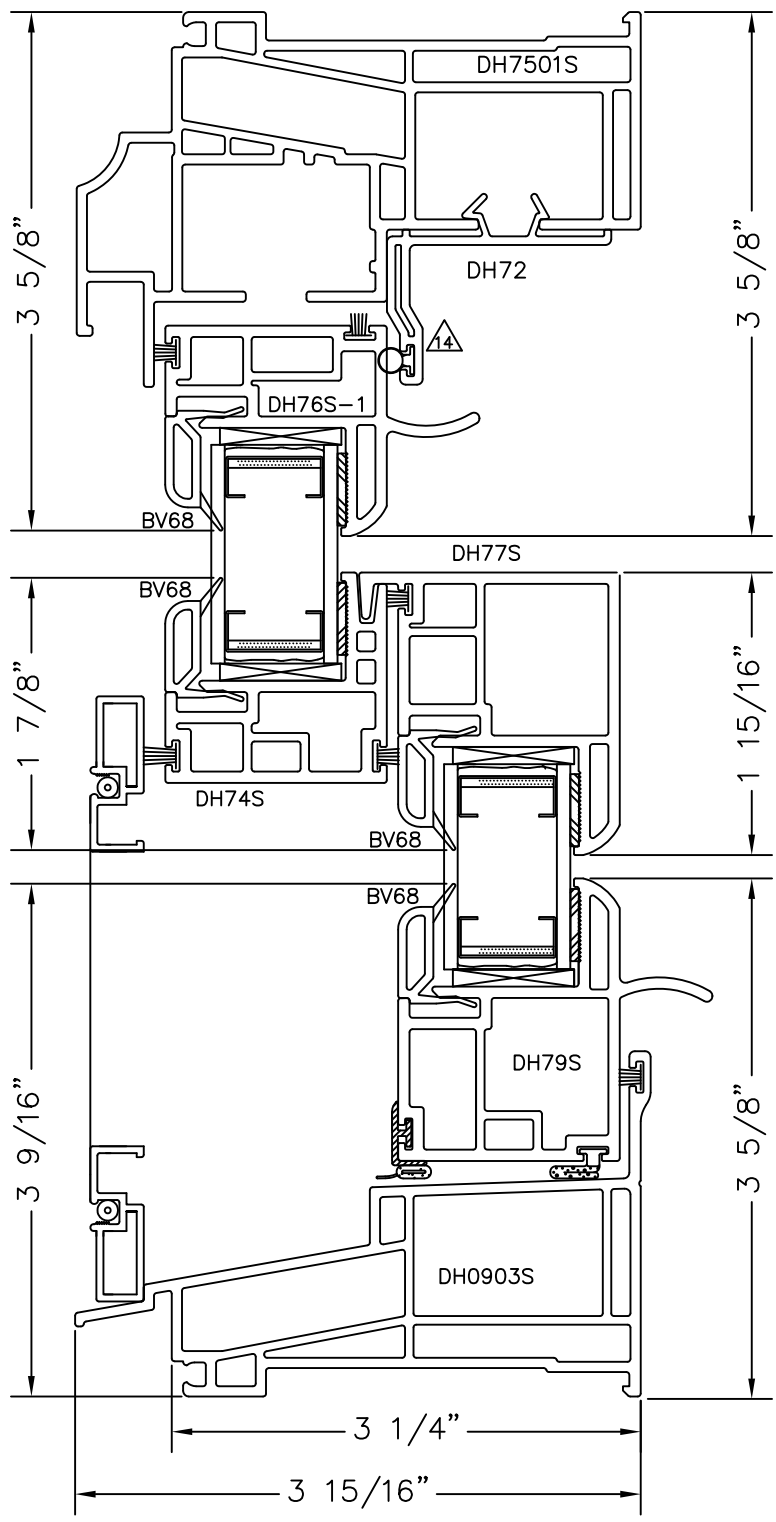

 <b>SIMONTON</b> W I N D O W S 1 Cochran Avenue Pennsboro, WV 26415		SIZE: DRAWING NO.: <b>A</b> 2004	REV.: 14
SCALE: FIT SHEET: 1 OF 1		DRAWN BY: T.D.D. DATE: 08/08/01	CHECKED BY: DATE:
SERIES: 6500 - DH		APPROVD BY: DATE:	
TITLE: VERTICAL ASSEMBLY DRAWING			

Dimensional Tolerances Unless Otherwise Specified	Decimals .X ± .03 .XX ± .01 .XXX ± .005	Angles 0° 30 min. .XXX ± .005
--	--	-------------------------------------

MATERIAL: RMS FINISH: EXCEPT AS NOTED ALLOY & TEMPER: WEIGHT: SURFACE AREA: FINISH TREATMENT:	VOLUME: PERIMETER:
---	-----------------------

**DISCLOSURE STATEMENT**

This document is the property of Simonton Windows, which retains all proprietary and other rights to its subject matter. This document is provided to the recipient on the expressed condition that it is not to be disclosed, reproduced in whole or part, nor used in conjunction with the design, manufacture or repair of goods for anyone other than Simonton Windows without its consent. This restriction does not limit the recipient's rights to utilize information contained in this document which is properly obtained from another source.

FILE: Q:\SHARE\DWGS\CAD\MANUALS\07-75 (6500)\Double Hung\Assembly

REV. #:	REVISIONS:	REVISED BY:	DATE:
1	ADDED "/79" TO STEEL REINF. FLAGS	P.A.T.	01/16/04
2	DH7501S PROFILE WAS DH7501.	P.A.T.	04/07/04
3	CHANGED SUPER SERVICE I.G. THICKNESS.	T.D.D.	07/09/08
.	.	.	.
.	.	.	.

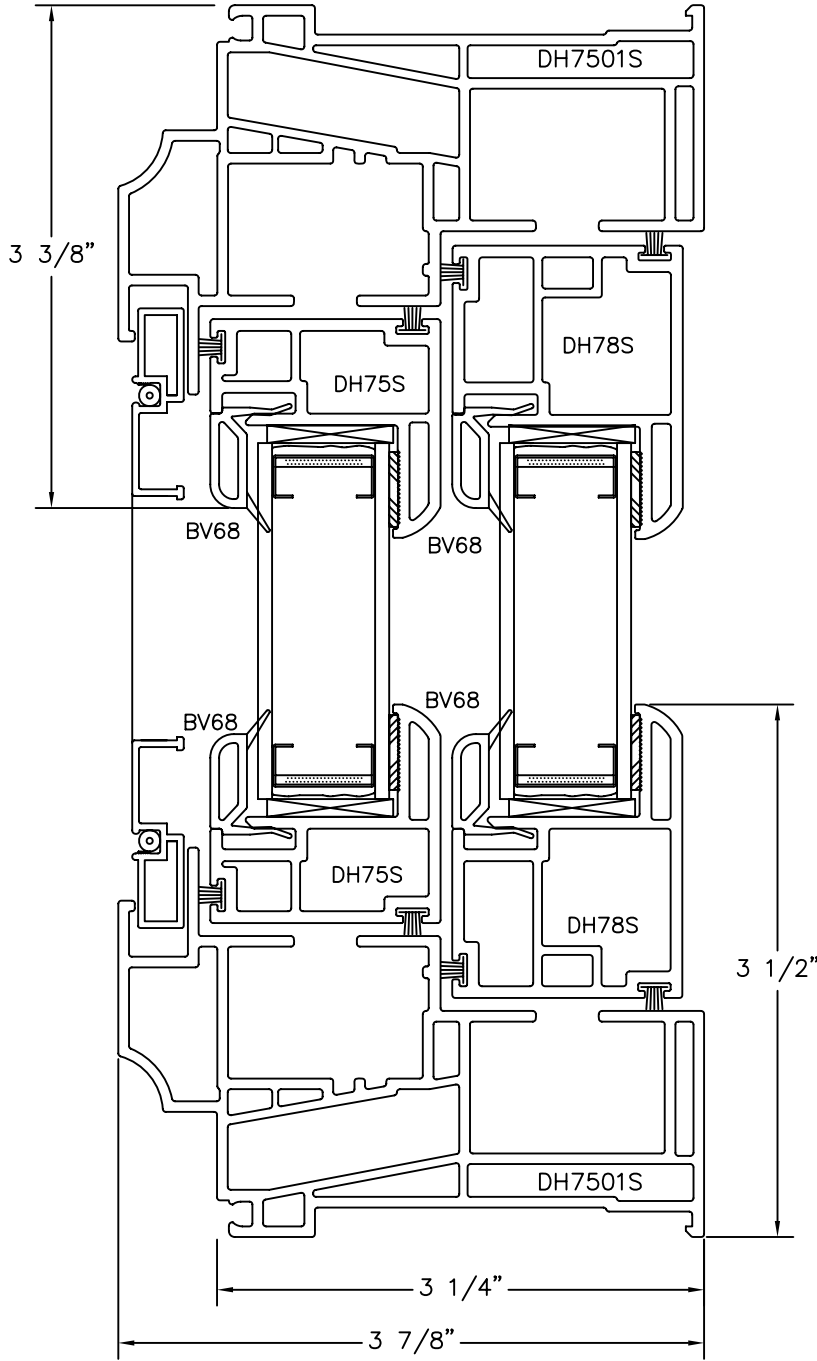

**SIMONTON®**  
W I N D O W S  
1 Cochran Avenue  
Pennsboro, WV 26415

SIZE: DRAWING NO.: **A** 2005 REV.: **3**  
 DRAWN BY: TDD DATE: 08/08/01  
 CHECKED BY: DATE:  
 APPRVD BY: DATE:  
 SHEET: 1 OF 1  
 SCALE: FIT  
 SERIES: 6500 - DH  
 TITLE: HORIZONTAL ASSEMBLY DRAWING

Dimensional Tolerances Unless Otherwise Specified

Decimals	Angles
.X ± .03	
.XX ± .01	0° 30 min.
.XXX ± .005	

MATERIAL:	
RMS FINISH:	EXCEPT AS NOTED
ALLOY & TEMPER:	
WEIGHT:	VOLUME:
SURFACE AREA:	PERIMETER:
FINISH TREATMENT:	

**DISCLOSURE STATEMENT**  
 This document is the property of Simonton Windows, which retains all proprietary and other rights to its subject matter. This document is provided to the recipient on the expressed condition that it is not to be disclosed, reproduced in whole or part, nor used in conjunction with the design, manufacture or repair of goods for anyone other than Simonton Windows without its consent. This restriction does not limit the recipient's rights to utilize information contained in this document which is properly obtained from another source.

FILE: 2005

1

2

1

2

REV. #:	REVISIONS:	REVISED BY:	DATE:
1	REMOVED BV18 AND ADDED BV68	P.A.T.	03/24/06
.	.	.	.
.	.	.	.
.	.	.	.

B

A

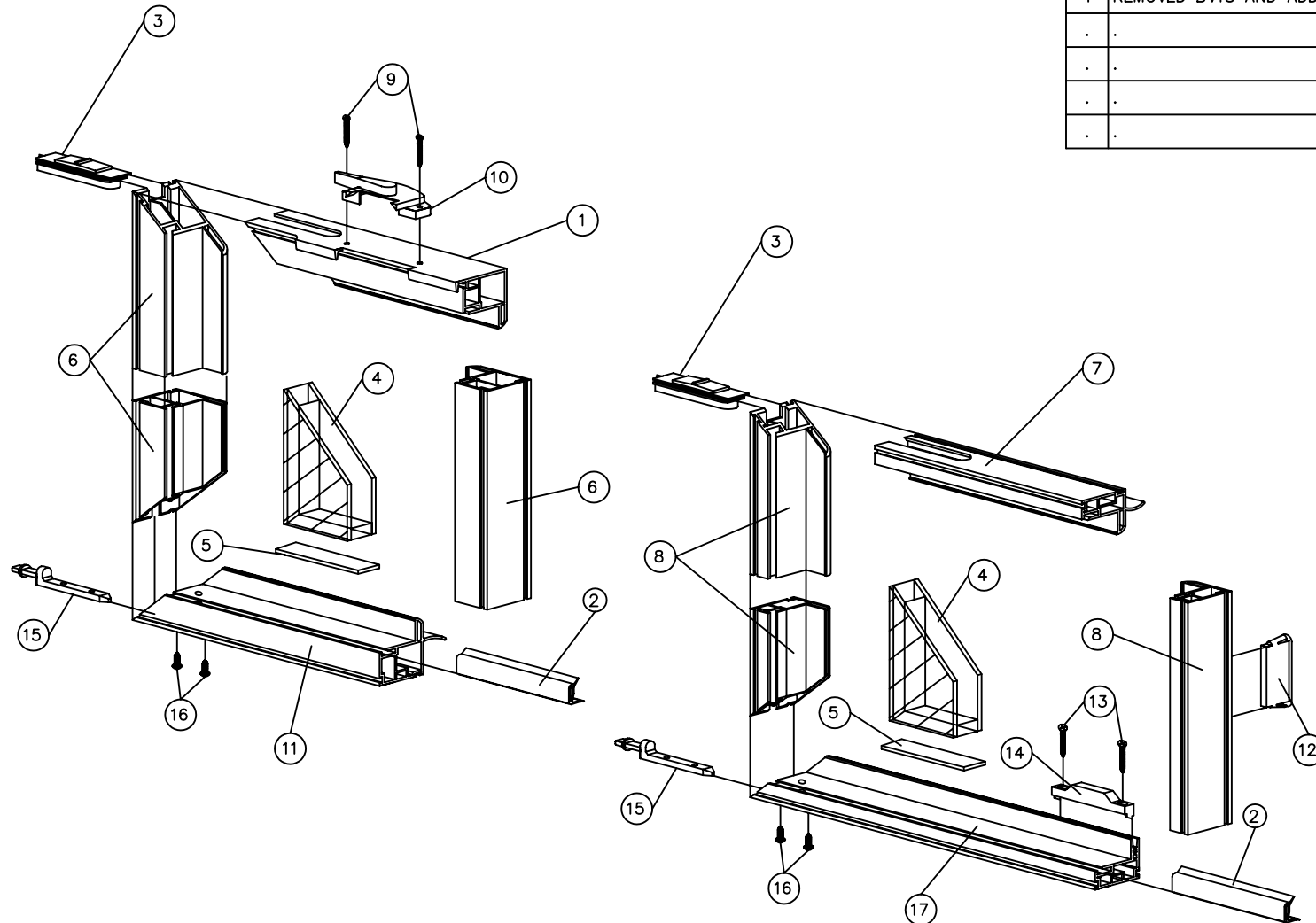

PARTS LIST

1	LOCK RAIL -DH77S
2	GLAZING BEAD -BV68 (4 SIDES)
3	TILT LATCH
4	INSULATED GLASS UNIT
5	GLAZING SHIM (4 SIDES)
6	BOTTOM STILE -DH78S
7	TOP LIFT RAIL -DH76S-1
8	TOP STILE -DH75S
9	LOCK SCREW
10	CAM LOCK
11	BOTTOM LIFT RAIL -DH79S
12	VENT LATCH
13	KEEPER SCREW
14	KEEPER
15	PIVOT BAR
16	PIVOT BAR SCREW
17	KEEPER RAIL -DH74S

B

A

DISCLOSURE STATEMENT

This document is the property of Simonton Windows, which retains all proprietary and other rights to its subject matter. This document is provided to the recipient on the expressed condition that it is not to be disclosed, reproduced in whole or part, nor used in conjunction with the design, manufacture or repair of goods for anyone other than Simonton Windows without its consent. This restriction does not limit the recipient's rights to utilize information contained in this document which is properly obtained from another source.

FILE: EX0087

MATERIAL:

RMS FINISH:	
EXCEPT AS NOTED	
ALLOY & TEMPER:	
WEIGHT:	VOLUME:
SURFACE AREA:	PERIMETER:
FINISH TREATMENT:	

Dimensional Tolerances  
Unless Otherwise Specified

Decimals	Angles
.X ± .03	0° ± 30 min.
.XX ± .01	
.XXX ± .005	



SIZE: A	DRAWING NO.: EX0087	REV.: 1
DRAWN BY: T.D.D.	DATE: 03/17/06	
CHECKED BY:	DATE:	

SCALE: FIT	SHEET: 1 of 1	APPR'V'D BY:	DATE:
------------	---------------	--------------	-------

SERIES: 6500 - DH

TITLE: SASH EXPLODED ISOMETRIC