

## 204.889 Acres

### State of Texas County of Guadalupe

**Fieldnotes**, for 204.889 Acres, situated in the A. M. Esnaurizar Survey, Abstract Number 20, Guadalupe County, Texas, being a portion of a 125.3 Acres, called First Tract and 80.7 Acres, called Second Tract, described in a Deed to Louis C. Heinemeyer and wife, Annie Heinemeyer, as recorded in Volume 234, Page 559 of the Official Public Records of Guadalupe County, Texas; said 204.889 Acres being more fully described by metes and bounds as follows;

**Beginning**, at a ½ Inch Iron Rod found, on the South Right-of-Way line of Texas F M 758, the Northwest corner of Lot 1, Karens Park Subdivision, as recorded in Volume 7, Page 16 of the Map and Plat Records of Guadalupe County, Texas, the East line of the said 125.3 Acre tract, for the Northeast corner of this tract;

**Thence**, South 0°36'52" East, departing the said South Right-of-Way, with the East line of the said 125.3 Acre tract, at 1601.04 Feet, pass a 1 Inch Iron Pipe Found, 0.68 feet Right of line, in all 4780.09 Feet, to a ½ Inch Iron Rod, with Orange Plastic Cap stamped "Urban Civil" set, on the apparent North Right-of-Way of Harborth Road (also known as Guadalupe County Road Number 125), for the Southeast corner of this tract, from whence a ½ Inch Iron Rod found, for the Southwest corner of a 6.088 acre tract, described in a Deed from Vicki S. Hartwick to Lori Katsmorak, as recorded in Volume 4178, Page 816 of the said Official Public Records, bears North 89°38'09" East, 669.57 Feet;

**Thence**, North 89°06'52" West, with the said apparent North Right-of-Way, 1138.89 Feet, to a ½ Inch Iron Rod, with Orange Plastic Cap stamped "Urban Civil" set, on the East line of the said 80.7 Acre tract, the West line of the said 125.3 Acre tract, for a corner of this tract;

**Thence**, North 88°47'14" West, continuing with the said apparent North Right-of-Way, at 179.26 feet, pass a ½ Inch Iron Rod found, 39.85 feet, Left of line, for a Northeast corner of a 36.8145 Acre tract, described in a Deed from Norman B. Harborth and Maxine Harborth to The Norman B. Harborth and Maxine Harborth Revocable Living Trust, as recorded in Volume 2464, Page 457 of the said Official Public Records, in all 736.07 Feet, to a ½ Inch Iron Rod, with Orange Plastic Cap stamped "Urban Civil" set, in the West line of the said 80.7 acre tract, for the Southwest corner of this tract, from whence, a ½ Inch Iron Rod found on the South Right-of-Way line of the said Harborth Rd. bears South 1°30'29" West, 39.74 Feet;

**Thence**, North 00°40'10" West, with the West line of the said 80.7 Acre tract, at 122.19 Feet, pass a ½ Inch Iron Rod found, 25.26 Feet, Left of line, for the Northeast corner of a 1.00 Acre tract, described in a deed from Walter Harborth and wife, Martha Harborth to Norman Harborth, as recorded in Volume 308, Page 150 of the said Official Public Records, in all 1821.25 Feet, to a 3 Inch Steel Pipe Fence Corner Post found, for the Southeast corner of a 46.7252 Acre tract, described in a Deed from Roger Lee Bormann, Brenda K. Varna and Audrey Diane Bormann to David Lehmborg and wife, Lori Gayle Lehmborg, as recorded in Volume 2785, Page 109 of the said Official Public Records, a corner of this tract;

# URBANCIVIL™

**Thence**, North 00°46'04" West, with the East line of the said 46.7252 Acre tract, the West line of the said 80.7 Acre tract, 2901.00 Feet, to a ½ Inch Iron Rod, with Orange Plastic Cap stamped "Urban Civil" set, on the South Right-of-Way of the said Texas F M 758, for the Northwest corner of this tract, from whence, a ½ Inch Iron Rod found for the Northwest corner of a 42.0449 Acre tract, described in a Deed from Nelson Bormann to Bartoskewitz Farm Foundation, as recorded in Volume 2803, Page 363 of the said Official Public Records, bears South 89°14'45" West, 1333.00 Feet;

**Thence**, North 89°14'45" East, with the said South Right-of-Way, 1883.74 Feet, to the **Point of Beginning**, containing 204.889 Acres (8,924,975 Square Feet) of Land, more or less.

Bearings are based on GPS, NAD83, State Plane Coordinates, Texas South Central Zone 4204.

Unless this fieldnote description, including preamble, seal and signature, appears in its entirety, in its original form, surveyor assumes no responsibility for its accuracy.

*Also reference accompanying Sketch of tract described herein.*

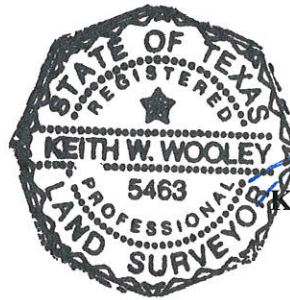

URBAN CIVIL

*Keith W. Wooley*  
Keith W. Wooley, R.P.L.S.  
License No. 5463