

Drawing Name: M:_Projects\040 - City of New Braunfels\028 - Das Rec. Parking Expansion\028_C_0_040_028 SITE PLAN.dwg User: ganith Apr 02, 2019 - 10:50am

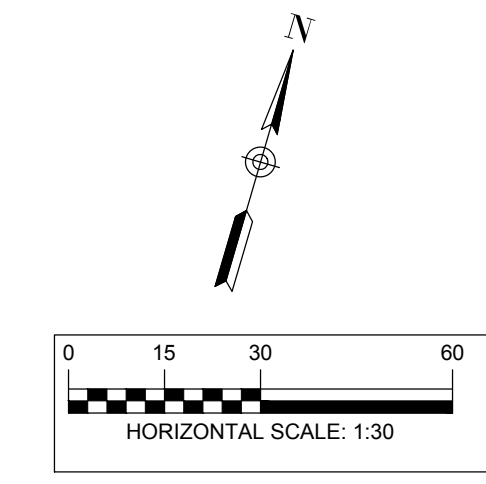
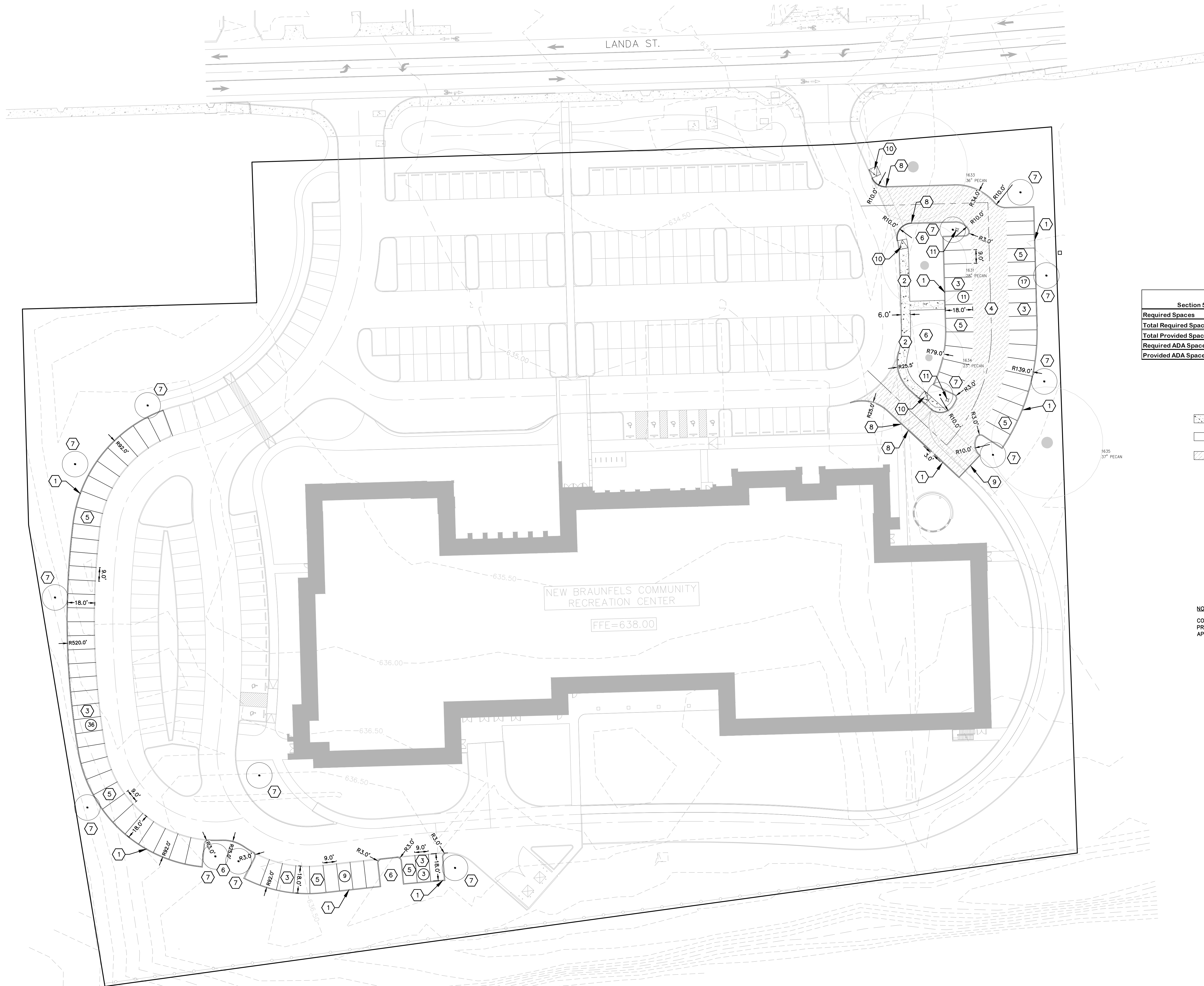

LEGEND

U.E.	UTILITY EASEMENT
D.E.	DRAINAGE EASEMENT
	A.D.A. RAMPS
	A.D.A. PARKING

Parking Table
Section 5.1.3 Chapter 144 Zoning - City of New Braunfels

Required Spaces	185
Total Required Spaces	185
Total Provided Spaces	294
Required ADA Spaces	7
Provided ADA Spaces	7

- KEY NOTES**
- 1 CONCRETE HEADER CURB
 - 2 CONCRETE SIDEWALK
 - 3 LIGHT DUTY PAVEMENT
 - 4 HEAVY DUTY PAVEMENT
 - 5 STRIPING
 - 6 LANDSCAPE AREA (COORDINATE WITH CITY)
 - 7 2" SHADE TREE
 - 8 1:1 TRANSITION TO RIBBON CURB
 - 9 ROLLOVER CURB
 - 10 A.D.A. RAMP
 - 11 PROPOSED LIGHT POLE
 - # PARKING COUNT
- NOTE:**
CONTRACTOR TO HAVE SPECIES APPROVED BY OWNER PRIOR TO CONSTRUCTION. (SEE SHEET C5.0 FOR APPROVED TREE LIST)

8200 W INTERSTATE 10
SAN ANTONIO, TX 78253
HMT@HMT.COM
P(210)562-3844 • F(210)562-3236
TBPE FRM F-10961
TBPLUS FRM 10153600



SITE PLAN
DAS REC PARKING EXPANSION

NO.	REVISION DESCRIPTION	REVISION DATE

DATE: MARCH 2019
DRAWN BY: DH
DESIGNED BY: EP
REVIEWED BY: CC
HMT PROJECT NO.: 040.028

SHEET
C3.0