

PLANNING COMMISSION – SEPTEMBER 8, 2021 – 6:00PM

Zoom & City Hall Council Chambers

Applicant/Owner: Land Consultants, Ltd, Co. (Caren Williams-Murch), agent for SatCharan Holdings LLC (Ravi Sahota), owner

Address/Location: 614 & 720 W Zipp Rd

PROPOSED SPECIAL USE PERMIT – CASE #SUP21-269

The circled numbers on the map correspond to the property owners listed below. All information is from the Appraisal District Records. The property under consideration is marked as “Subject Property”.

- | | |
|---|--|
| 1. ELLIS BRENDA | 26. ESCOBAR DANIEL SANTOS |
| 2. KRETZMEIER PAUL H | 27. STEVENSON RICHARD ROY & LAUREN MAE |
| 3. SCRIBNER TERI | 28. STONE GREG |
| 4. ZAVALA JUAN F & LINDA S | 29. SCHOENHERR DUANE & GLORIA |
| 5. HAMBRICK GRACE | 30. WILLIAMS JASON & DANNALYN |
| 6. NEW BRAUNFELS INDEPENDENT SCHOOL DISTRICT | 31. MASON JERMAINE S & TONYA S |
| 7. HARRISON MATTHEW T & SANDRA V | 32. YANEZ ROBERT JR & KELLI-ANNE P BARROW |
| 8. YOUNG GLEN & JAMIE | 33. AMESCUA KRISTIN M & CODY J YORK |
| 9. PROFFITT ROBERT S & JENNIFER M | 34. KOKKEBY SEAN & STEPHANIE |
| 10. CRISSY ANGELA G & JOANN M HOLLIDAY | 35. GERELL-STILES APRIL R & GREGORY E STILES |
| 11. CAVAZOS JESUS ELI & MELISSA DENISE | 36. BUSHBY FRANCIS RUSSELL & SYLVIA LEA |
| 12. KLEIN JANET WALL | 37. GUNN BARBARA |
| 13. GUILLEN KRISTEN | 38. MOORE ROBERT EUGENE & MONICA C |
| 14. HAHN AARON | 39. WARD LEE ALAN & KIMBERLEY MARIE |
| 15. MARES EILEEN R | 40. RITSON BARBARA S & GREGG E |
| 16. RIDGEMONT HOME OWNERS ASSOCIATION INC | 41. MELVIN LISA D |
| 17. ROBLES TOM R & PAULA MERRILL ROBLES | 42. SOLIS HECTOR JR & CLAUDIA R |
| 18. GUERRA-TREVINO NORMA & RUBEN TREVINHO | 43. RODRIGUEZ ROBERT LEE & NAISHCA MARIE MOODY |
| 19. SCOTT RANDY J & LISA M | 44. RUNDELL BRENDON M & LOURDES |
| 20. BRAY DEBORAH E | 45. WINBERG BRYAN |
| 21. HOOKER CLINTON DAVID & KATHERINE J | 46. FREKING JONATHAN & SHYANN MORGAN |
| 22. WOLF ANDREW S & DALLAS | 47. TOWNSEND JONATHAN ANDREW & HANNAH MICHELE |
| 23. VALENZUELA MARTHA | 48. RAYGOZA BRENDAN C |
| 24. PULTE HOMES OF TEXAS LP | 49. DAVIS MEGAN L & TEXAS J |
| 25. CANTON CHRISTOPHER MICHAEL & JYOTI KAY CANTON | 50. FLASHER MARIA L & BENJAMIN M |

SEE MAP

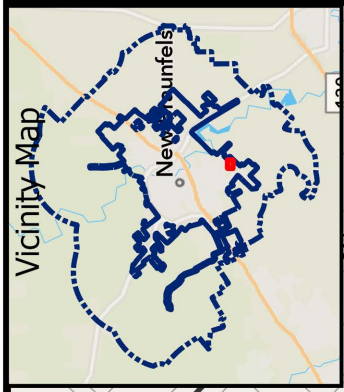
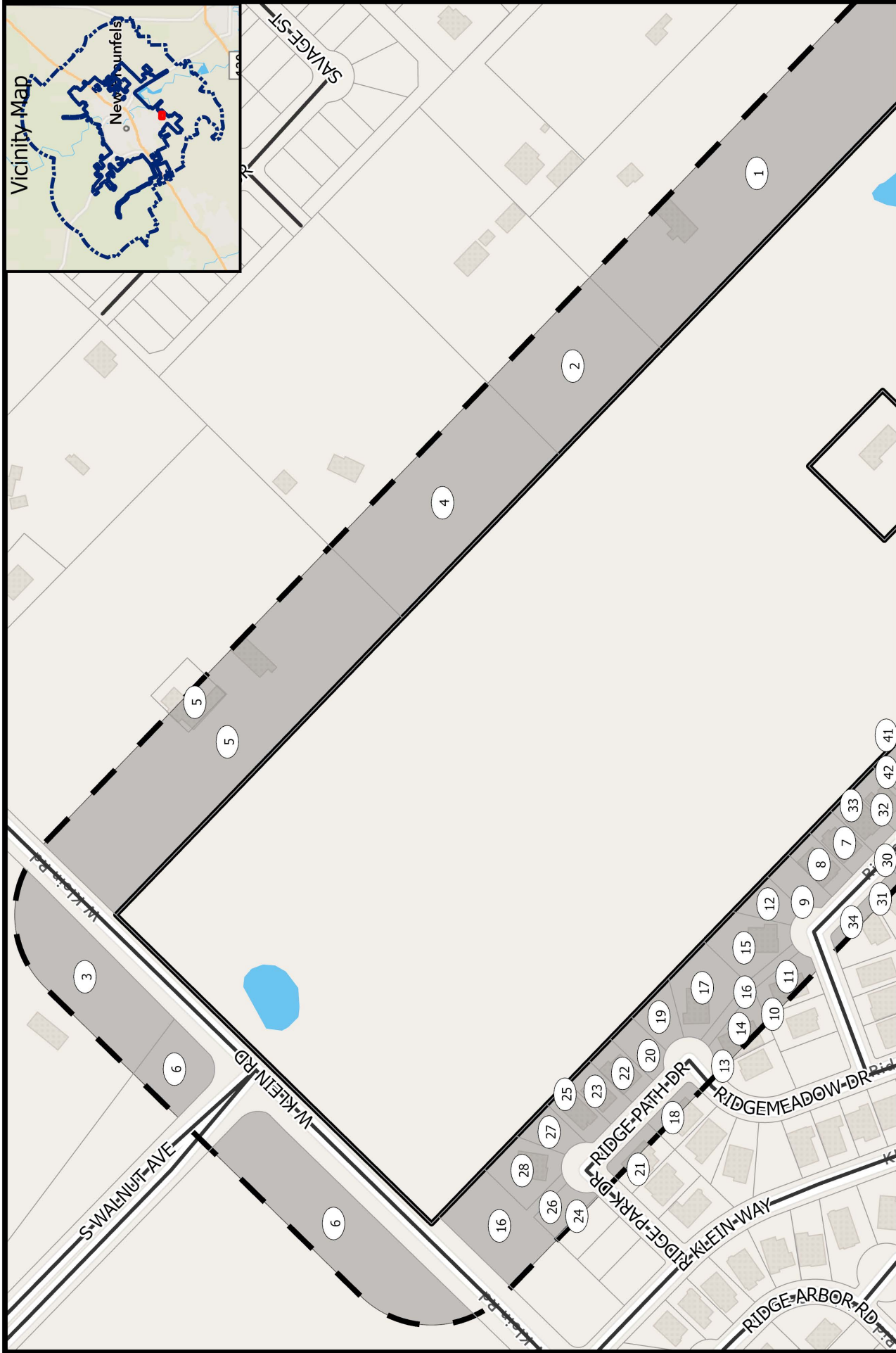

SUP21-269 **SUP request to include multiple districts**

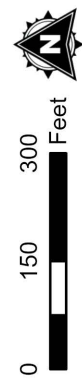

DISCLAIMER: This map and information contained in it were developed exclusively for use by the City of New Braunfels. Any use or reliance on this map by anyone else is at that party's risk and without liability to the City of New Braunfels, its officials or employees for any discrepancies, errors, or variances which may exist.

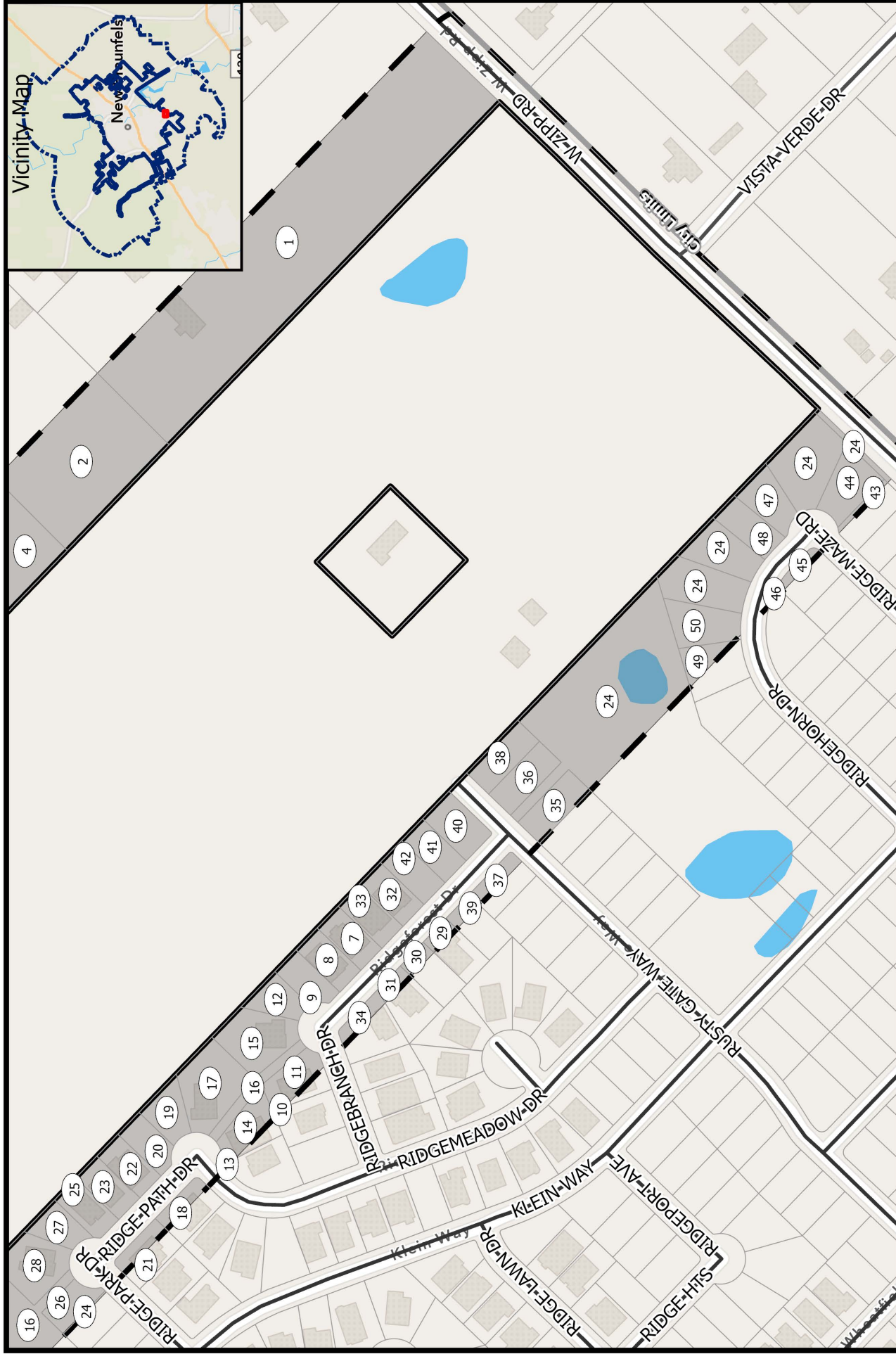

SUP21-269

SUP request to include multiple districts



DISCLAIMER: This map and information contained in it were developed exclusively for use by the City of New Braunfels. Any use or reliance on this map by anyone else is at that party's risk and without liability to the City of New Braunfels, its officials or employees for any discrepancies, errors, or variances which may exist.