

# PROPOSED SITE PLAN

## SITE DATA

Proposed Zoning: SUP for Multifamily Residential Use

Gross Acreage: 17.8 Acres

Yield: 97 Units

Density: 5.5 Units Per Acre

Total Parking Provided: 426 Spaces

Garage Spaces: 163 Spaces (1 per 2-bed unit / 2 per 3 & 4-bed unit)

Driveway Spaces: 194 Spaces (2 per unit)

On-Street Parking: 69 Spaces (1 side of drive aisle & amenity center)

Total Parking Required: 232 Spaces

\* Note: On-street parallel parking stalls will not be striped and are shown for location and counting purposes only. Garage and driveway parking stalls will not be striped either.

## SEC MORNINGSIDE DR & RON RD | DEVELOPMENT / SITE PLAN

08/30/2021

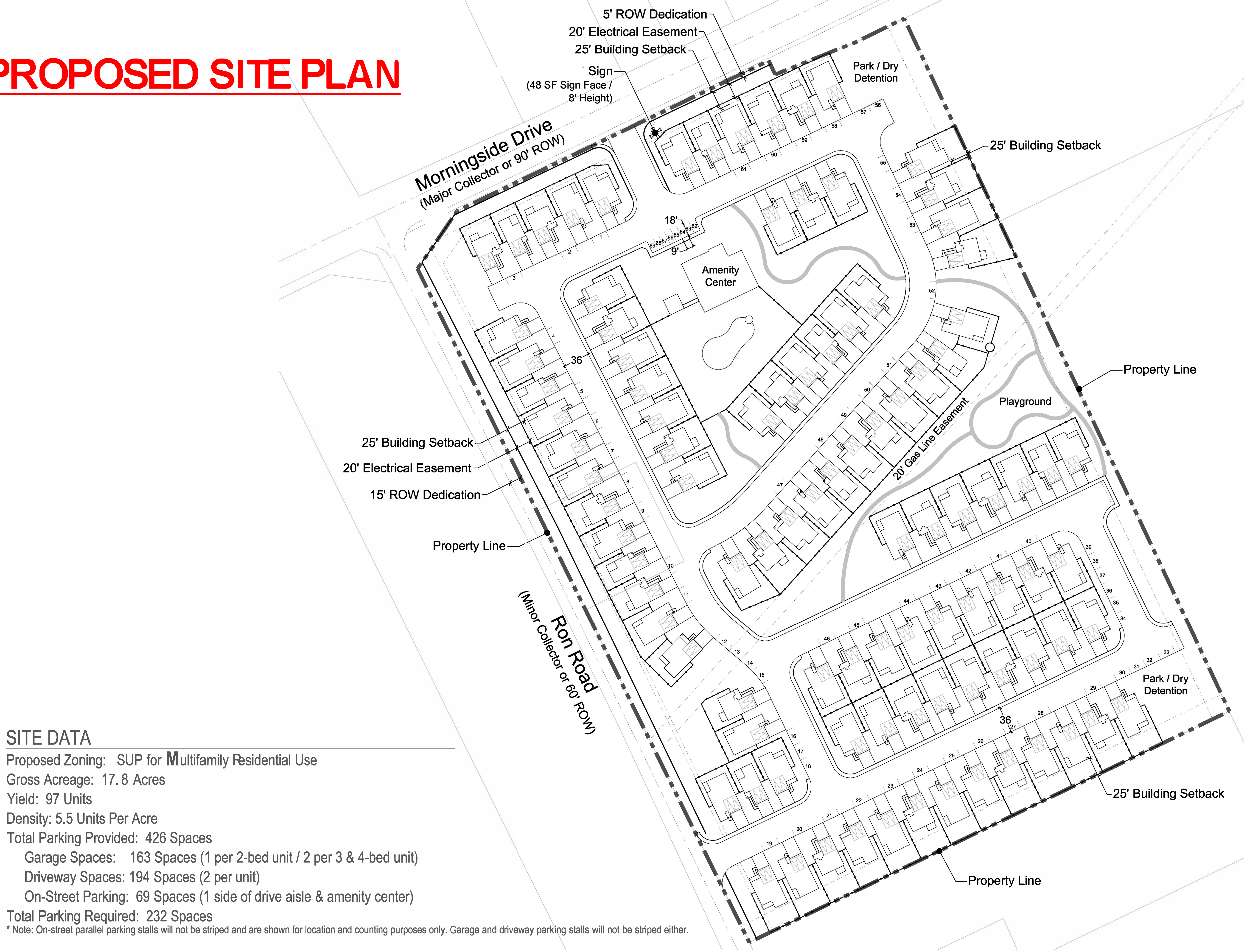

Actual building footprints subject to change.

