

**SUP21-0267**  
**Special use permit for Short Term Rental**

0 60 120  
 Feet

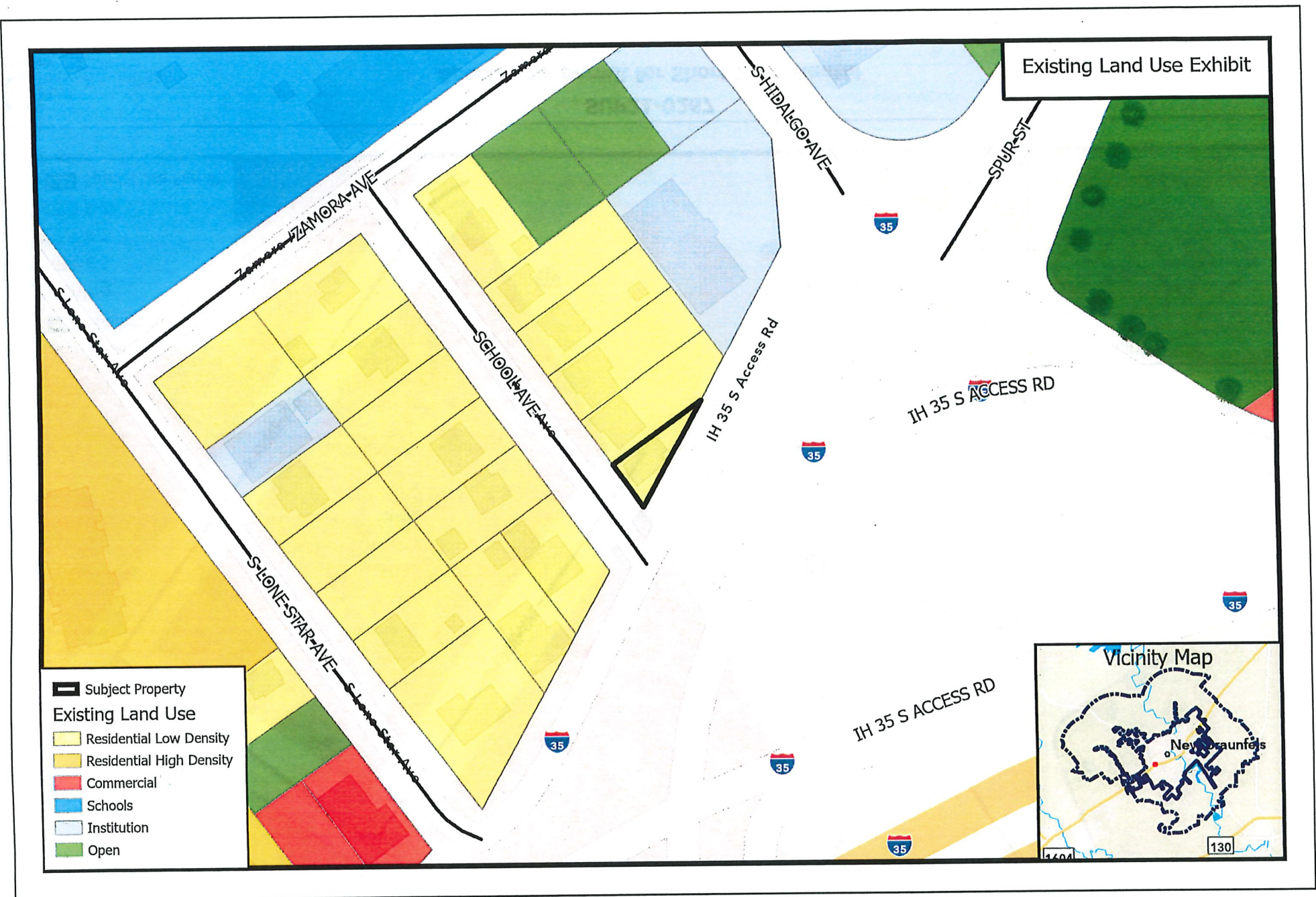





**SUP21-0267**  
**Special use permit for Short Term Rental**

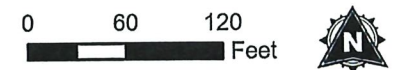



## Envision New Braunfels

A SPECIAL PLACE BY DESIGN

- ◆ Located in the Oak Creek Sub-Area
- ◆ Near a Transitional Mixed-Use Corridor
- ◆ Near Existing Outdoor Recreation and Civic Centers and future Market Center

## Future Land Use Map

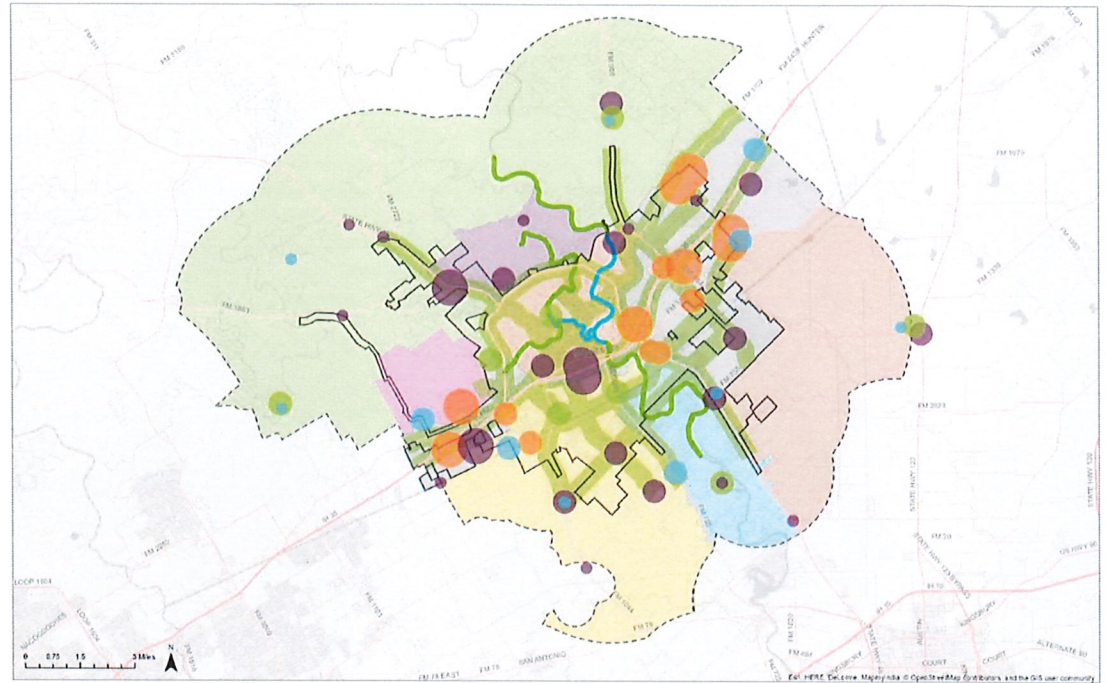

- **Action 1.3:** Encourage balanced and fiscally responsible land use patterns.
- **Action 1.6:** Incentivize infill development and redevelopment to take advantage of existing infrastructure
- **Action 1.14:** Ensure regulations do not unintentionally inhibit the provision of a variety of flexible and innovative lodging options and attractions.





Document Path:  
Y:\Tools\Tools\PLN\_STRBB\STR and BB Tool.aprx

## SUP21-0267 Short Term Rental Map

Source: City of New Braunfels GIS  
Date: 8/23/2021

0 380 760  
Feet  
1:9,461



DISCLAIMER: This map and information contained in it were developed exclusively for use by the City of New Braunfels. Any use or reliance on this map by anyone else is at that party's risk and without liability to the City of New Braunfels, its officials or employees for any discrepancies, errors, or variances which may exist.